

OPERATION INSTRUCTIONS

1. Connect adapter(24V 0.5A) with oil diffuser(DC plug socket)
2. Add 90-100ml water with measuring cup, do not exceed the max line.
3. Three modes of POWER key: ON / intermission / OFF
4. Press LIGHT button: 7 colors changing in circulation, press again to choose the fixed color you like.
5. The mist can long last 3-5 hours. Auto shut off when the water runs out.

IMPORTANT

1. This diffuser only works with 24V DC adapter.
2. Do not power on when waterless.
3. Clean the middle hole of the water tank with cotton swab regularly after 3-5 times using.
4. Do not add essential oils from mist outlet hole directly, wrong operation may cause outlet hole blocked.
5. Do not pour water into the air hole when water pouring, wrong operation may cause buttons out of control, keep the water temperature below 60 celsius degrees.
6. Not rated for damp locations, keep bottom part always dry, and keep water tank in dry and cool place.
7. Keep away from listed places and reduce the unnecessary risks: Where the temperature is higher than 40 celsius degrees, where has strong magnetic or dust, on carpet, where has gas or related danger areas.

NOTE

Most mist output issue is caused by incorrect operation(Please follow the user instruction to add water and oils). If you got any confusions when using this item, please contact us freely, we promise you will get a satisfied solution very shortly.

Essential Oil Diffuser User Manual

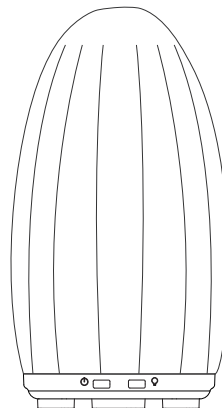

IMPORTANT

1. Read and follow all cautions and instructions, do not open no user serviceable parts inside.
2. Risk of fire hazard and forbidden to put in water and against electric shock, Only rated for indoor use.
3. Recommend users for age 18 and up.

Do ask complete warranty card and secures its under warranty period from the distributor.

OPERATION INSTRUCTION



1. (DC 24V-500mA 5.5*2.1MM) Connect with power adapter

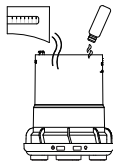

2. Add water first and not exceed MAX line(100ml), then add 2 drops of essential oil

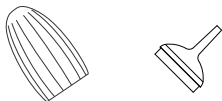

3. Close the cap in position and then to install the cover

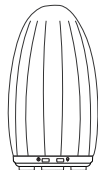

4. Press button and start MIST, Press button and start LIGHT

Water Pour Direction

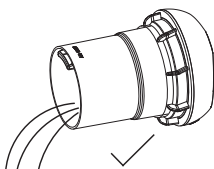

Pour water with indicated direction

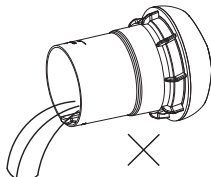

Wrong direction pouring may goes to air hole

THE PARAMETERS

Item Name: Aromatherapy oil Diffuser	DC Type: Dia Ø5.5MM*2.1MM
Weight: 700G	Frequency: 2.4MHz±0.1
Dimension: 92MM*92MM*150MM	Working Tem.: 0℃to 40℃
Tolerance:±1MM	Water Tank Capacity: 90-100ML
Driver Supply: DC24V 500mA	Mist Longlast: 3-5 H

BUTTON INSTRUCTIONS

Button Name	Condition
Mist Power	Three working modes: ON / intermission / OFF
Light Control	7 Changing Color Lights Auto color changing cycles & fixed color mode

ATTENTION:

1. The power will be cut off automatically when run out of water.
2. The light can be always power on as a night light.

FAQ

Q: How much water does this diffuser hold?

A: The water capacity is 100ml, add water below the max line.

Q: Indicator light work regularly, but why no mist comes out?

A: The water added too much, the mist outlet hole is blocked.

Q: Sometimes the mist works sometimes it doesn't, what happen?

A: Added too much oils in the water tank, which would cause bubbles appear and blocked the mist outlet hole. Keep water below the max line.

Q: Why the bubbles would appear and leak out the water tank?

A: Add too much drops of aroma oils, more drops would cause more bubbles. Add 2-3 drops is enough while diffusing.

Q: The diffuser light turn on, but the mist stop working after a couple months?

A: The mist hole was blocked. Use a cotton swab to clean the middle hole of the water tank, then add water and oils to start work again.